

[www.klauke.com](http://www.klauke.com)

**K 5**



Serialnumber

Abb. ähnlich  
pic. similar

WE.3353\_F © 02/2000 R&D-2

Gustav Klauke GmbH • Auf dem Knapp 46 • D-42855 Remscheid • Telefon +49 2191 907 0 • [www.klauke.com](http://www.klauke.com)

**Klauke**<sup>®</sup>

  
**EMERSON**<sup>™</sup>

K 5



2 years  
Warranty

World wide  
Tool  
Service

KLAUKE ASC  
International Service Center

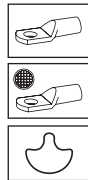

**WORK**





**SERVICE**

**DON'T DO**

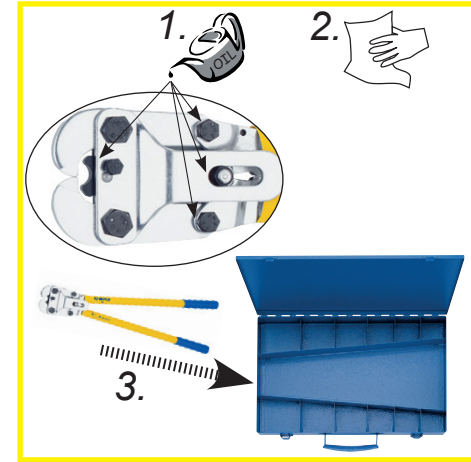
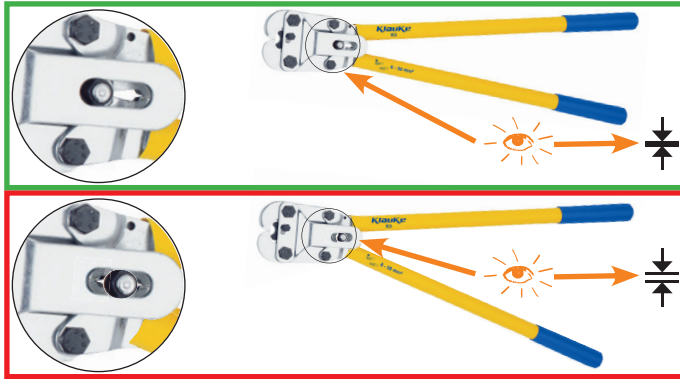
**DON'T DO**

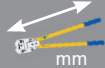
**K 5**



Art.-Nr. #	 mm	 kg	geeignet für suitable for	Verb.material Connection material	Pressbereich mm <sup>2</sup> Crimping range mm <sup>2</sup>	Pressform Crimping mold
<b>K 5</b>	600	2,4	Rohrkabelschuhe und Verbinder „Normalausführung“ Tubular cable lugs and connectors „standard type“		6 - 50	
			Rohrkabelschuhe und Verbinder für feindrähtige Leiter Tubular cable lugs and connectors for fine stranded conductors	